

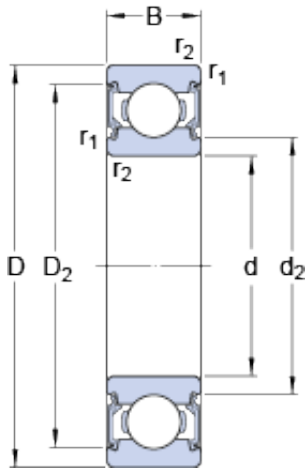

BEARING CORP.OF AMERICA



6005-2RSLTN9/HC5C3WT SKF Hybrid Deep Groove Ball Bearings

Bearing No. 6005-2RSLTN9/HC5C3WT

6005-2RSLTN9/HC5C3WT Bearing 2D drawings and 3D CAD models

Size	47x25x12 mm
Bore Diameter	47 mm
Outer Diameter	25 mm
Width	12 mm
d	25 mm
D	47 mm
B	12 mm
d ₂	29.7 mm
D ₂	42.2 mm
r _{1,2} - min.	0.6 mm
d _a - min.	28.2 mm
d _a - max.	29.5 mm
D _a - max.	43.8 mm
r _a - max.	0.6 mm
Basic dynamic load rating - C	11.9 kN
Basic static load rating - C ₀	6.6 kN
Fatigue load limit - P _u	0.275 kN
Reference speed	40000 r/min
Limiting speed	22000 r/min
Calculation factor - k _r	0.025
Calculation factor - f ₀	14.3
Category	Single Row Ball Bearings
Inventory	0.0
Manufacturer Name	SKF



BEARING CORP.OF AMERICA

Minimum Buy Quantity	N/A
Weight / Kilogram	0.066
Product Group	B00308
Enclosure	2 Seals
Precision Class	ABEC 1 ISO P0
Maximum Capacity / Filling Slot	No
Rolling Element	Ball Bearing
Snap Ring	No
Internal Special Features	Silicon Nitride Rolling Element Electrical Insulated
Cage Material	Polyamide
Enclosure Type	Contact Seal
Internal Clearance	C3-Loose
Inch - Metric	Metric
Long Description	25MM Bore; 47MM Outside Diameter; 12MM Outer Race Width; 2 Seals; Ball Bearing; ABEC 1 ISO P0; No Filling Slot; No Snap Ring; Silicon Nitride Rolling Element Electrical Insulated Internal Special
Other Features	Deep Groove Low Friction NBR Seal Hybrid Silicon Nitride Rolling Element WT Standard Grease
Category	Single Row Ball Bearing
UNSPSC	31171504
Harmonized Tariff Code	8482.10.50.68
Noun	Bearing
Keyword String	Ball
Manufacturer URL	http://www.skf.com
Manufacturer Item Number	6005-2RSLTN9/HC5C3W T



BEARING CORP.OF AMERICA

Weight / LBS	0.073
Inner Race Width	0 Inch 0 Millimeter
Bore	0.984 Inch 25 Millimeter
Outside Diameter	1.85 Inch 47 Millimeter
Outer Race Width	0.472 Inch 12 Millimeter
d_2	29.7 mm
D_2	42.2 mm
$r_{1,2}$ min.	0.6 mm
d_a min.	28.2 mm
d_a max.	29.5 mm
D_a max.	43.8 mm
r_a max.	0.3 mm
Basic dynamic load rating C	11.9 kN
Basic static load rating C_0	6.55 kN
Fatigue load limit P_u	0.275 kN
Calculation factor k_r	0.025
Calculation factor f_0	14.3
Mass bearing	0.073 kg